



The Crosby Straightpoint Handheld plus is a rugged and versatile digital handheld display. It has an extensive range of features and is suitable for all Crosby SP load cell products.

At the heart of the ergonomically designed Handheld plus is a powerful PCB providing industry leading features such as user selectable units of measure (tonnes, lbs, kg and kN), programmable audible overload alarm (HHP & SW-HHP), peak hold, pre-set tare and a user resettable (HHP & SW-HHP) overload counter.

This crucial overload alarm counter is a requirement for many safety and quality control departments, as it keeps track of overload events, allowing the load cell in question to be removed from service immediately, following the calibration voiding overload event. The load cell in question can then be sent out for proper testing and, if necessary, recalibration before re-entering service.

The HHP is suitable for connection via cable to any Straightpoint cabled load cell product and easily adapted to any other manufacturers' load cell product with a mv/v output.

In addition to the standard HHP, the SW-HHP is suitable for connection to any Straightpoint wireless load cell, has a range of up to 1000m/3280ft (ATEX 500m/1640ft) and is supplied as standard with the Radiolink plus load cell.

## Features & Benefits

- Displays up to 4 load cells simultaneously
- Wireless range 1000m or 3280ft (ATEX 500m or 1640ft)
- Low battery warning
- Signal strength warning
- Overload counter
- User settable 90db audible overload alarm
- Multiple display units – tonnes, lbs, kg and kN
- 200Hz Peak hold
- Annual calibration reminder

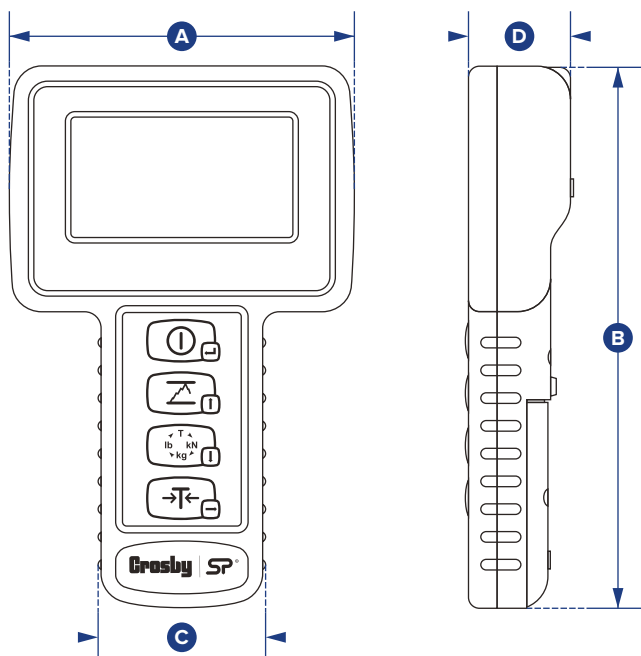

SP Model	HHP	SW-HHP	SW-HHP ATEX
Part Number	2789030	2789126	2789442
Battery Type	2 x AA		2x AA Energizer L91
Battery Life	100 hrs continuous	40 hrs continuous	40 hrs continuous
Display Type	240x128 multi-line dot matrix with backlight		240x128 multi-line dot matrix
Audible Alarm	Yes	Yes	No
Operating Temp	-10 to +50 °C / 14 to 122 °F		
Protection	IP65 / NEMA 4X		
Excitation	3.3V	N/A	
Max Sensitivity	3mV/V		
Range (Max)	N/A	1000m or 3280ft	500m or 1640ft
Connectivity	6-way female binder 723 socket	Wireless 2.4 GHz	Wireless 2.4 GHz
Loadcells	1	4	4
A	118.2 or 4.65"		
B	186 or 7.32"		
C	57 or 2.24"		
D	35 or 1.38"		

Also available with  
hazardous area approval



**ATEX / IECEx**  
Ex ia II CT4 Ga

Certification number: **SW-HHP ATEX**  
IECEx SIR 15.0072X / Sira 15ATEX2196X / CSAE 22UKEX1267X

When ordering ATEX/IECEx version of SW-HHP,  
order using code: **SW-HHP-ATEX**

**Please note:** There is no audible alarm with ATEX

## Accessories available for the handheld:

**Wall or Cab Mount Bracket**  
SP model / Part No.  
SU3282 / 2789228

**Rugged Rubber Boot**  
SP model / Part No.  
SU4045 / 2789232